



KIT # 19432

100 sq.ft Floating Dock

Medium
Freeboard

10'x10'

	HARDWARE		Size	Qty	VERIF
BOX 19160	19160	Kit Hard. A Float Dock		1	
	13305	Inside corner	6" x 5" x 1/4"	4	
	13300	Back Plate	5" x 5" x 1/4"	6	
	10002	Inside joist corner	2-3/4" x 5" x 1/8"	2	
	10003	Back plate	2" x 5" x 1/8"	4	
	22100	1/2" x 3" (32x), 3/8" x 2 1/2" (8x) carriage bolt kits		1	
BOX 19161	19161	Kit Hard. B Float Dock		1	
	13300	Back Plate	5" x 5" x 1/4"	4	
	10002	Inside joist corner	2-3/4" x 5" x 1/8"	10	
	10003	Back plate	2" x 5" x 1/8"	20	
	22102	1/2" x 3" (8x), 3/8" x 2 1/2" (40x) carriage bolt kits		1	
BOX 19171	19171	Anchor Chain Plate Set (2x12003)		1	
	12003	Anchor chain plate	10" x 3,5" x 1/4"	2	
Pick	22162	3/8" x 4 1/2" (8x), 1.75" washer (8x) lag bolt kits		3	

FLOATS				
14107	E-380 Foam Filled Float	24" x 48" x 12"	6	

SHOULD YOU ENCOUNTER ANY DIFFICULTIES WITH THIS PRODUCT,
PLEASE CONTACT OUR CUSTOMER SERVICE AT 1-800-585-1237



Lumber & screws needed
Cedar, Hemlock or Treated Wood



19432
100 sq.ft

Lumber Lengths	For Sub-Structure made of 2" x 6" or 2" x 8"			
	2" x 6" lumber	qty	OR	2" x 8" lumber qty
	2" x 6" x 10ft	35		2" x 6" x 10ft 27
				2" x 8" x 10ft 8

Cut list		10'x10'	qty
Side pieces	A	120"	2
Interior joists	B	116-3/4"	2
End pieces	C	116-3/4"	2
Girts	D	37-3/4"	6
Floors supports	E	120"	6
Decking boards	F	120"	21

Screws

8

8

24

48

168

Wood Screws	#10 x 3 1/2"	256
-------------	--------------	-----

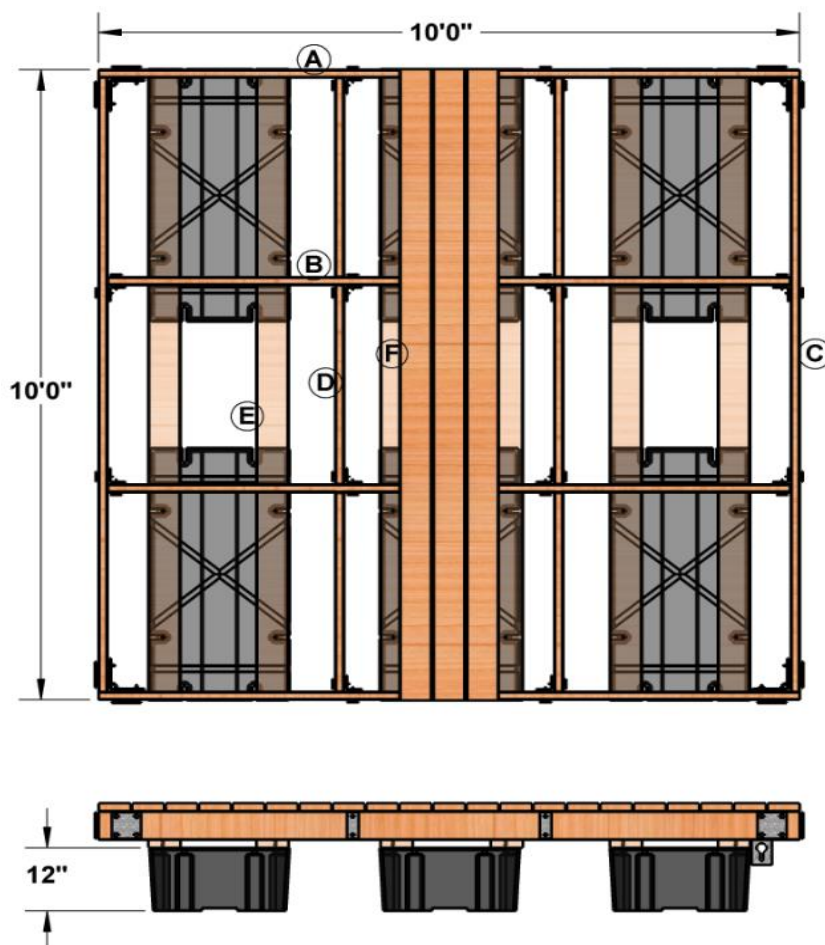

SHOULD YOU ENCOUNTER ANY DIFFICULTIES WITH THIS PRODUCT,
PLEASE CONTACT OUR CUSTOMER SERVICE AT 1-800-585-1237

